

Infinity Series 2045

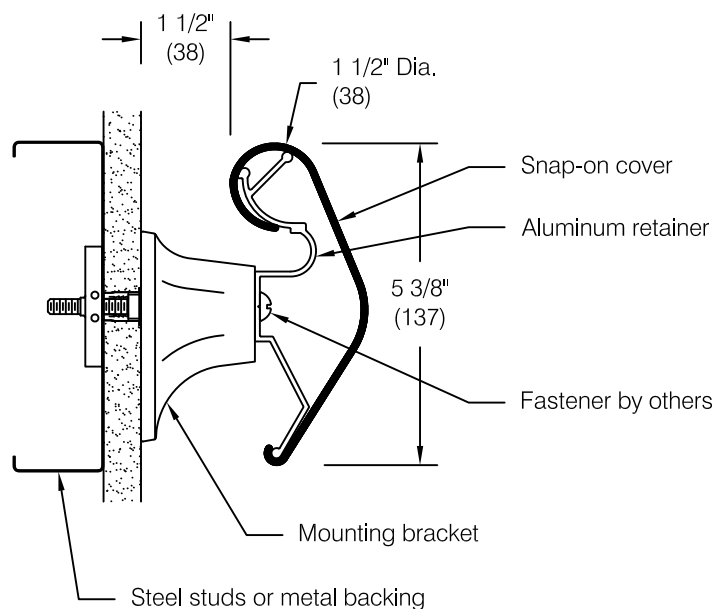

This installation instruction
is applicable to:

2045

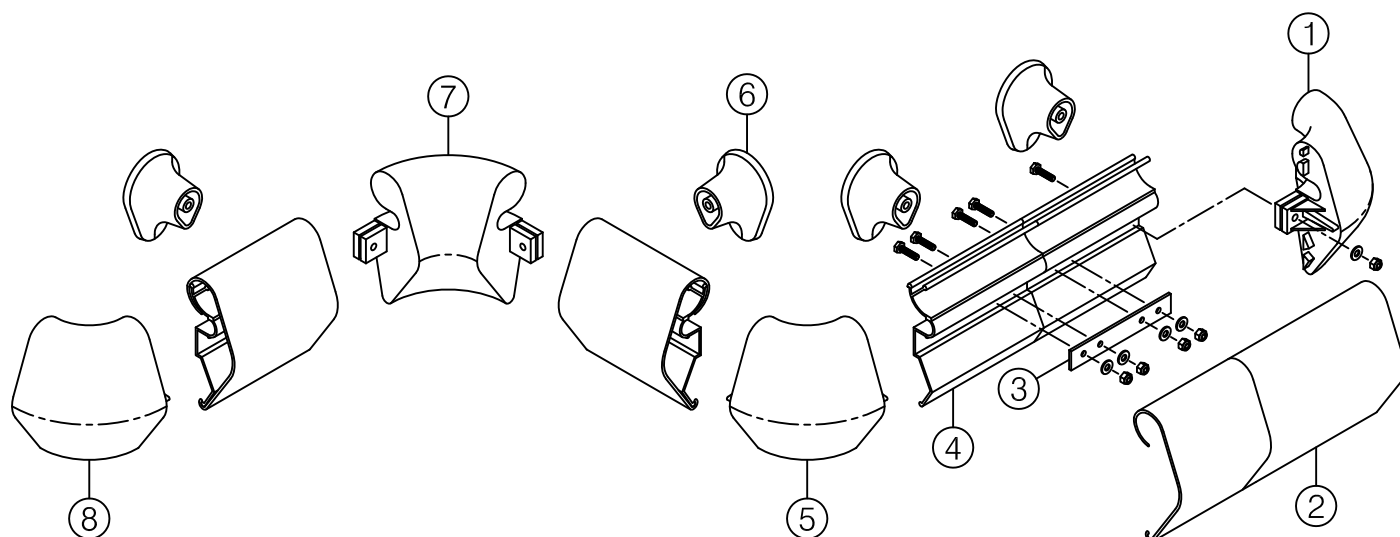

Component Part Numbers:

- 1) Right return
- 2) Snap-on cover
- 3) Splice
- 4) Aluminum retainer
- 5) Outside corner
- 6) Bracket
- 7) Inside corner
- 8) Left return

- Step 1:** Determine top of handrail height and snap a chalk line 2 ¾" below for centerline of mounting hardware, see **fig 1**.
- Important:** Store material in a clean dry place where the temperature is maintained above 50°F (10°C). Walls and rooms should be maintained at a minimum of 65°F (18°C) for at least 48 hours prior to installation. Acclimate materials to normal building conditions for at least 24 hours before cutting and installing.
- Step 2:** Cut aluminum retainer. See **Cutting Adjustment Diagrams and Schedule** for adjustments to aluminum retainer length at wall returns, inside corners and outside corners. Refer to **Minimum Layout Configurations** for additional information.
- Important:** All cuts must be square and deburred
- Step 3:** Layout aluminum retainer "face up", mark and drill bracket mounting hole locations.
Bracket mounting holes must be spaced:
- Not to exceed 32" on center
 - 1 1/2" to 6" from end of aluminum retainer at returns and corner accessories
 - A minimum of 4" from end of retainer at splices to avoid interference with splice hardware (shown in **fig 6**)
 - To align with metal studs (on metal stud construction) or preferably with horizontal metal backer plate (by others)
- Note:* Use groove in retainer to locate centerline for drilling, see **fig 2**
- Step 4:** Locate and drill bracket mounting holes in wall construction using the aluminum retainer as a template or by careful measurement. Choice of hardware will dictate hole diameter.
- Step 5:** Insert molded accessories into end of retainer, press firmly to ensure molded part is seated squarely against the end of the retainer. Drill accessory mounting holes using the accessory as a template, see **fig 3**.
- Step 6:** Attach molded returns, outside corners and inside corners to retainer with accessory seated firmly and squarely while tightening. Fasten with ¼" bolt, flat washers and nylon lock-nut provided.
Caution: Do not use lock washers, use flat washers only. Install a flat washer between nut and rear molded tab and between bolt head and front molded tab. Tighten to 10 ft-lbs maximum torque, see **fig 4**.
- Step 7:** Mount assembly to wall with the appropriate hardware according to wall construction. See **step 8** for splicing information.
Suggested hardware:
- Drywall: Toggler® brand toggle bolts
 - Masonry: Plastic Alligator® insert
- Step 8:** Refer to **fig 5** for splicing of aluminum retainer as required on longer handrail lengths. Always locate splice joints a minimum of 4" from bracket locations. For best results offset butt joint in cover from splice in aluminum retainer.
- Step 9:** Measure between accessories (corners and returns) and cut snap-on cover.
Important: All cuts must be square and deburred
- Step 10:** Snap cover in place over aluminum retainer.

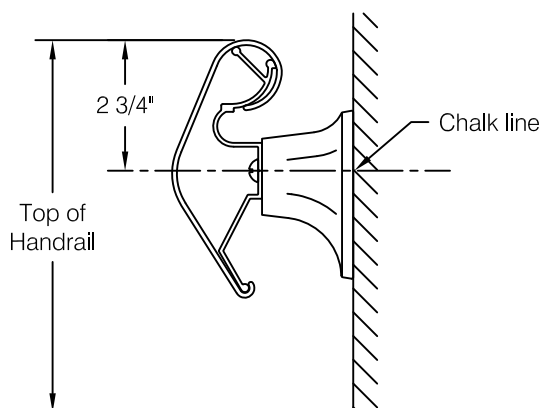

fig 1

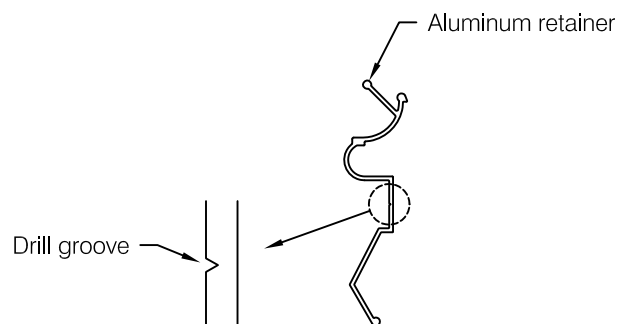

fig 2

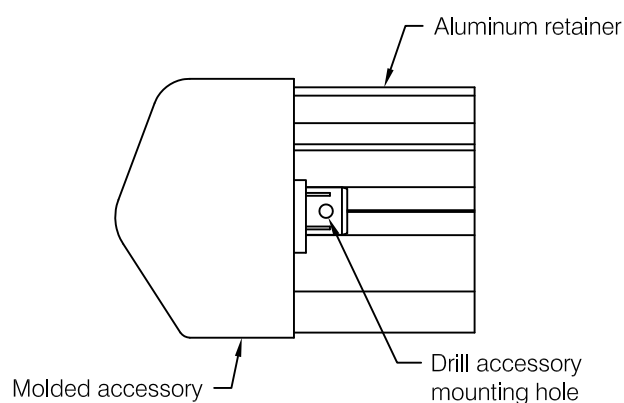

fig 3

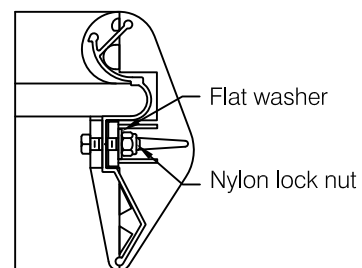

fig 4

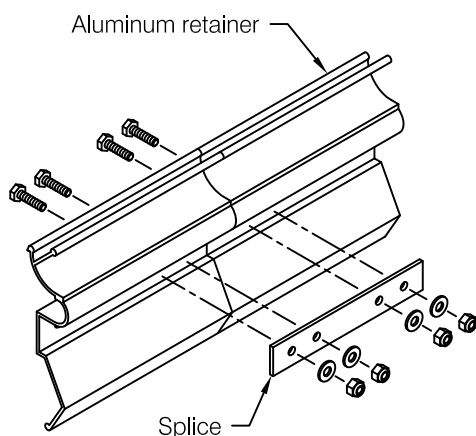
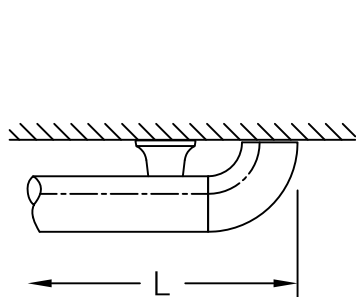
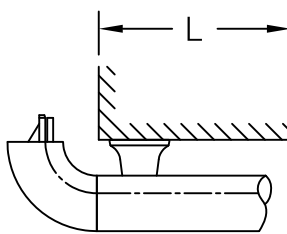

fig 5

Cutting Adjustment Diagrams and Schedule



Return



Outside Corner

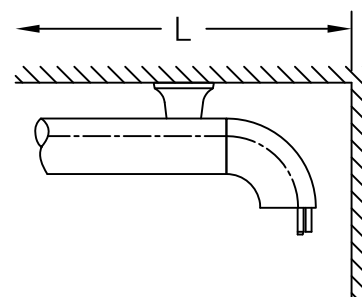

Inside Corner

Aluminum Retainer & Snap-on Cover

Return	$L - 3 \frac{3}{4}"$
Outside Corner	$L + \frac{1}{16}"$
Inside Corner	$L - 5 \frac{3}{16}"$

Important: Install aluminum retainer and molded accessories before cutting the snap-on cover.

Minimum Layout Configurations

