

# Defender Series 2330B - 3 1/2" Endwall

## Features:

- Custom lengths, angles, and wing sizes are available
- Type 304 stainless steel

## Mounting Options:

- Standard mounting

### Adhesive:

Construction adhesive supplied separately

- Optional mounting

### Standard Drilling:

Clearance holes for #8 fastener. ABSS-113, #8 x 1 1/2" (38) oval head sheet metal screw and ABCW-132 stainless cup washer supplied separately as required.

### Countersunk Drilling:

Countersunk holes for #6 fastener. ABSS-134, #6 x 1 1/2" (38) oval head sheet metal screw supplied separately as required.

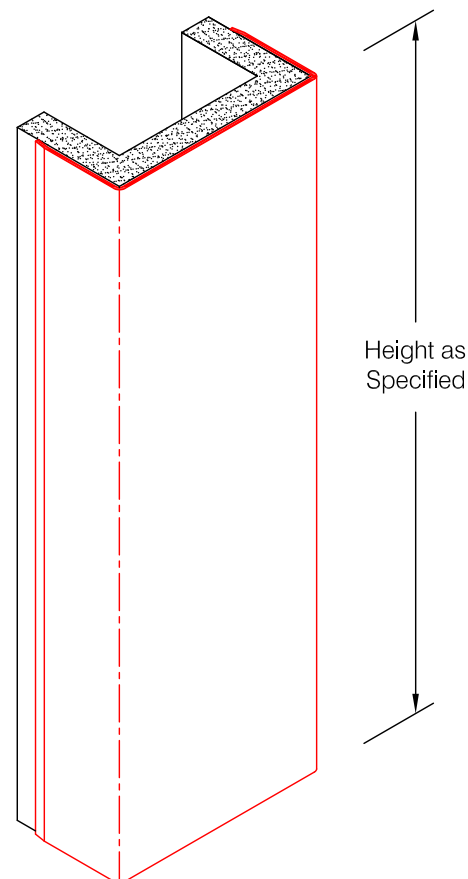
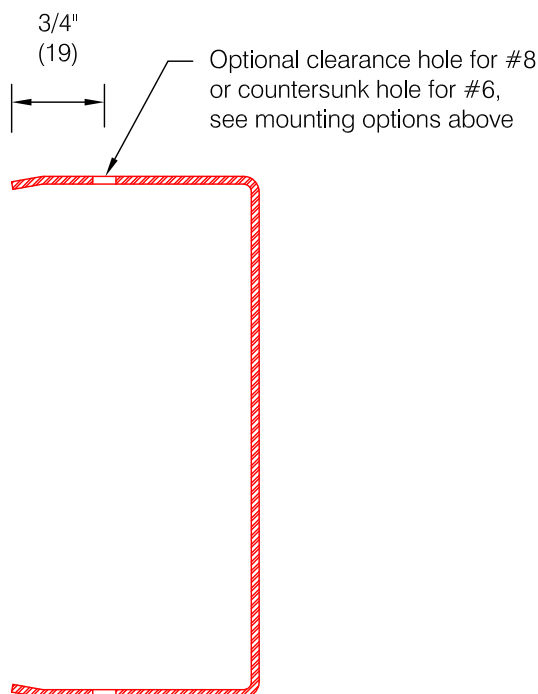
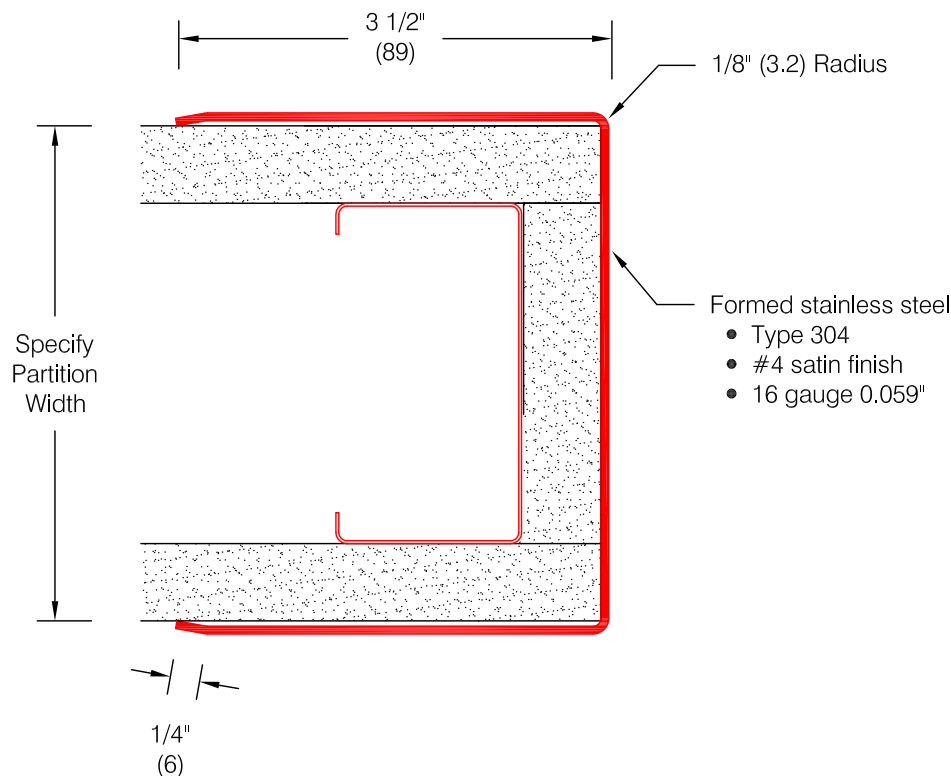

## Spacing for optional drilling:

- Standard spacing: 3" (76) from each end and spaced evenly not to exceed 36" (914) oc